

SOFT LANDSCAPE WORKS

Generally

All planting operations shall conform to the requirements of BS4428
All trees & plants shall be of local provenance & comply with the requirements of BS3936
All horticultural sundries including herbicides shall be applied / fitted in accordance with manufacturers' instructions.
All trees & plants shall be thoroughly watered after planting and kept watered during hot, dry weather.

Services / Utilities

Prior to commencement of works the location of overground and underground utilities shall be confirmed by the contractor where any conflicts with the landscape proposals shall be assessed and amendments to accommodate these agreed.

Preparation for Planting

Soils

Imported soils shall fully comply with the requirements of BS3882 for General Landscape Purposes and shall be;

- from an as dug source - screened and manufactured soils shall not be allowed
- free of stones greater than 75mm in any one dimension
- free of pernicious weeds
- accompanied by a source and test certificate

Formation Grades

Formation grades shall be free of deleterious materials, rubbish, debris, plant material and shall be freely draining for which purpose an allowance shall be made for ripping the substrate to a depth of 500mm

Soiling

Minimum soil depths shall be as follows;
For EHS & HS Trees: 750mm cu pits
For Feathered Trees: 500mm cu pits
For Shrubs and Groundcovers: 450mm depth
Grassed Areas: Min 150mm depth

Planting

Specimen Trees

Shall comprise EHS (Extra Heavy Standard) & HS (Heavy Standard) Trees
EHS Trees shall have a girth of 11-16cms. HS Trees 2-4cm. They shall be supplied root-balled and planted in excavated and scarified pits minimally sized 750mm cube. Pits shall be free draining with a gravel layer 200mm at the base. Pits shall be backfilled with a mixture of topsoil and TPMC (Tree planting and mulching compost). Trees shall be planted approx. 75mm above adjacent ground level at nursery depth. Each tree shall be fixed via an approved staking system. Each tree shall be mulched to a radii of 600 mm to the base

Feathered Trees

Feathered Trees shall have a girth of 6-8cm and shall be supplied bare rooted and planted in pits minimally sized 500mm cube. Pits shall be free draining and shall be backfilled with a mixture of topsoil and TPMC (Tree planting and mulching compost). Trees shall be planted approx. 75mm above adjacent ground level at nursery depth. Each tree shall be fixed via an approved staking system and filled with a rabbit guard. Each tree shall be mulched to a radii of 600 mm to the base

Shrubs and Groundcovers

Planting species and numbers shall be in accordance with the plant schedule, substitutions shall not be allowed without the consent of the CA. Plants shall be planted at a rate of 4-5 plants per m.sq in bays prepared and top-soiled to a depth of 450mm. The backfill material shall be site topsoil mixed with TPMC 25% by volume. All plants shall be watered after planting. At planting a slow release fertiliser shall be applied, and after planting all beds shall be mulched with an ornamental grade mulch to a depth of 75mm.

Grass Seeding

Grassed areas shall be topsoiled to 150mm depth
A proprietary pre-seeding fertiliser shall be applied to a prepared seed bed prior to seeding after which the areas shall be seeded with an A19 General purpose grass seed mixture by Germinal GB or similar approved.
Sowing rate: 35g/m²sq

PLANTING SCHEDULE

Species	Planted	Specification	Nr
			All TBC
EHS (Extra Heavy Standard Trees)			
Prunus avium Flore Plena	As shown	ANS 14 - 16cm Girth RB	19
Tilia tomentosa Brabant	As shown	ANS 14 - 16cm Girth RB	10
Sorbus intermedia	As shown	ANS 14 - 16cm Girth RB	18
Heavy Standard Trees			
Acer campestre	As shown	12 - 14cm Girth RB	5
Alnus cordata	As shown	12 - 14cm Girth RB	5
Quercus robur	As shown	12 - 14cm Girth RB	1
Feathered Trees			
Acer campestre	As shown	2.5-3.0m Hgt Open Grown	12
Prunus avium	As shown	2.5-3.0m Hgt Open Grown	3
Quercus robur	As shown	2.5-3.0m Hgt Open Grown	4
Woodland (Main) Mix B - 831m.sq			
Acer campestre 25%	1.5m centres	Transplants 600-900mm	140
Alnus glutinosa 25%	1.5m centres	Transplants 600-900mm	140
Crataegus monogyna 15%	1.5m centres	Transplants 600-900mm	85
Prunus avium 5%	1.5m centres	Transplants 600-900mm	30
Ilex aquifolium 5%	1.5m centres	3L Pots	30
Quercus robur 15%	1.5m centres	Transplants 600-900mm	85
Viburnum opulus 10%	1.5m centres	Transplants 600-900mm	55
Shrubs & Groundcovers 670m.sq			
Cotoneaster c. Decorus	4 per m.sq	3L Pots	908
Cornus Midwinter Fire	4 per m.sq	3L Pots	880
Cornus s. Sibirica	3 per m.sq	3L Pots	984
Cornus s. Flavrimea	3 per m.sq	3L Pots	770
Lonicera pileata	3.5 per m.sq	3L Pots	1148
Polygonum Donald Lowndes	4 per m.sq	3L Pots	876
Potentilla Abbottswood	4 per m.sq	3L Pots	560
Prunus Otto Luyken	3.5 per m.sq	3L Pots	1120
Rosa Kent	4 per m.sq	3L Pots	864
Rosa Suffolk	4 per m.sq	3L Pots	768
Viburnum davidii	4 per m.sq	3L Pots	916



KEY

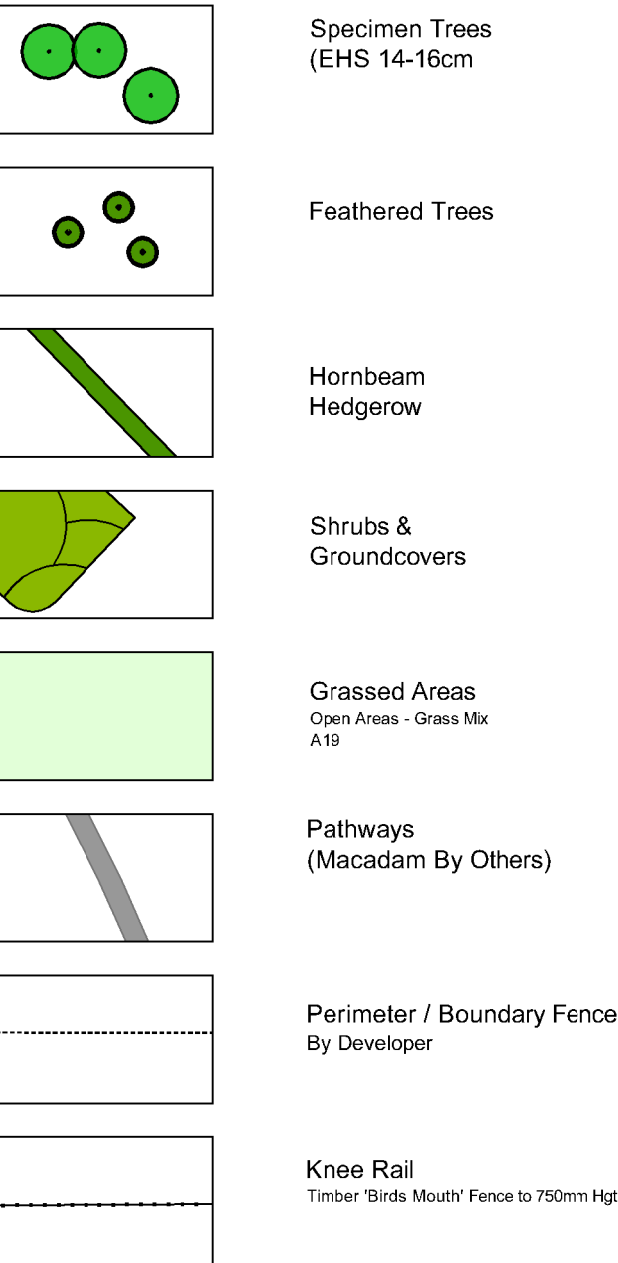

LANDSCAPE MAINTENANCE

Annual maintenance operations shall be for a period of 5 yrs and shall include;

To Trees:

Watering (as required during periods of drought)
Check / Firm ties and stakes (2 x pa)
Remove / prune dead wood (1 x pa)
Replace tree failures annually (1 x pa)
Apply spring / autumn fertiliser (1 x pa)
Remove stakes / ties when requested (1 x on completion)

To Woodland Beds:

Watering (as required during periods of drought)
Handweed (10 x pa)
Litter picking (10 x pa)
Remove / prune dead wood (1 x pa)
Maintain mulch depth at 75mm (1 x pa)
Replace plant failures annually (1 x pa)
Apply spring / autumn fertiliser (1 x pa)
Remove rabbit proof guards when requested

To Herbaceous / Groundcover Areas

Watering (as required during periods of drought)
Handweed (10 x pa)
Litter picking (10 x pa)
Remove / prune dead wood (1 x pa)
Maintain mulch depth at 75mm (1 x pa)
Replace plant failures annually (1 x pa)
Apply spring / autumn fertiliser (1 x pa)

To Grassed Areas:

Watering (as required during periods of drought)
Litter picking (10 x pa)
Cut & Maintain at max 75mm Hgt (10 x pa)
Remove cut arisings (10 x pa)
Overseed bare areas (as required)
Apply selective herbicide as directed (allow 1 x pa)

THESE NOTES ARE FOR GUIDANCE PURPOSES ONLY.
A COMPREHENSIVE LANDSCAPE SPECIFICATION
SHALL BE PREPARED FOR TENDERING AND
CONSTRUCTION

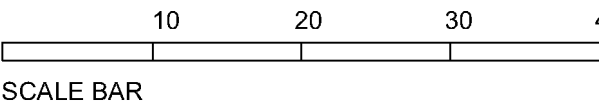
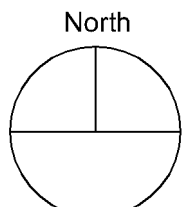

Issue 4: Planning Aug 2019

Minor reduction Car Parking

Issue 3: Planning July 2019

Minor amendments to turning heads from Barratt Homes site

Issue 2: Planning June 2019

Amended Stadium Layout as Scheme C

Robert Rodger Associates Ltd

Landscape Architecture * Landscape Planning * Urban Design

'Rivington', Church Lane, Farnold, Chester CH3 6QD

Client	Gaming International		
Project	Abbey Meads		
Drg. Title	Area 3 Stadium - Landscape Layout		
Date	Aug 2019	Scale: 500@A1	Drg: RAL.325.04
Drawn	RKR		Issue: 04